

**Cross linking time:**  
20 minutes at 20°C  
**Hardness:**  
70 Shore D  
**Dielectric strength:**  
20 kV/mm  
**Specific weight:**  
1,07 kg/dm<sup>3</sup>  
1,7 kg/dm<sup>3</sup> per Rayresin Tan 3,8  
**Water absorption:**  
0,8% max

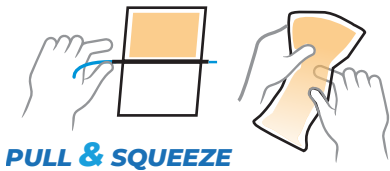

**PULL & SQUEEZE**

# RAY RESIN

Two-component epoxy resin for installations up to 1 kV.

Resin for electrical insulation and for the protection of thermosetting LV and MV accessories. The two components, the base resin and hardener, are mixed in close contact to trigger the cross linking reaction. Excellent bonding to metal, plastic and rubber components.

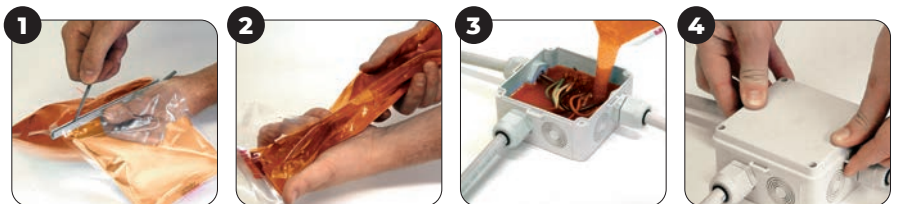

**1** Remove the separator from the Rayresin bag.

**2** Mix the 2 components.

**3** Pour Rayresin in the tray (1' max).

**4** Installation completed.



PRODUCT / Item	Colour	Package type	Total quantity
RAYRESIN 170 100170-000	●	Two-component single dose bags	170 gr
RAYRESIN 210 100210-000	●	Two-component single dose bags	210 gr
RAYRESIN 420 100420-000	●	Two-component single dose bags	420 gr
RAYRESIN TAN 3,8 100380-TAN	●	Drum with mineral charge	3.8 kg